

WWW.GRPTANK.COM

GRP SECTIONAL PANEL WATER TANK



Ceo Greeting

SMC CO.,LTD produces environmental friendly products such as GRP Sectional Panel Water Tanks, GRP Manhole and Manhole Cover.

All of products are produced under a strict quality control system and also guaranteed its qualities with a strict warranty policy in order to give more confidence to customers.

Our high efficient facilities and advanced technologies can meet all of our customer's needs in quality and safeties.

All members of SMC CO.,LTD are devoted to produce only the top quality products to meet all of our customer's requirements.

We promiss to our customers as below

Promiss 1. Very Fast Delivery

Promiss 2. Very Competitive Price with high quality.

Promiss 3. Very Fast Response and Warranty.

Our goal is to do our best for the benefit of our customers and desire to preserve beautiful nature and resources .

Sincerely yours.

SMC CO.,LTD
CEO H.K.KIM



Patent for Earthquake



WRAS

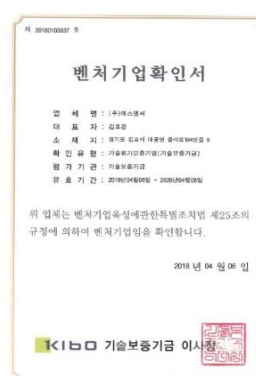

VENTURE FIRM

Main Products

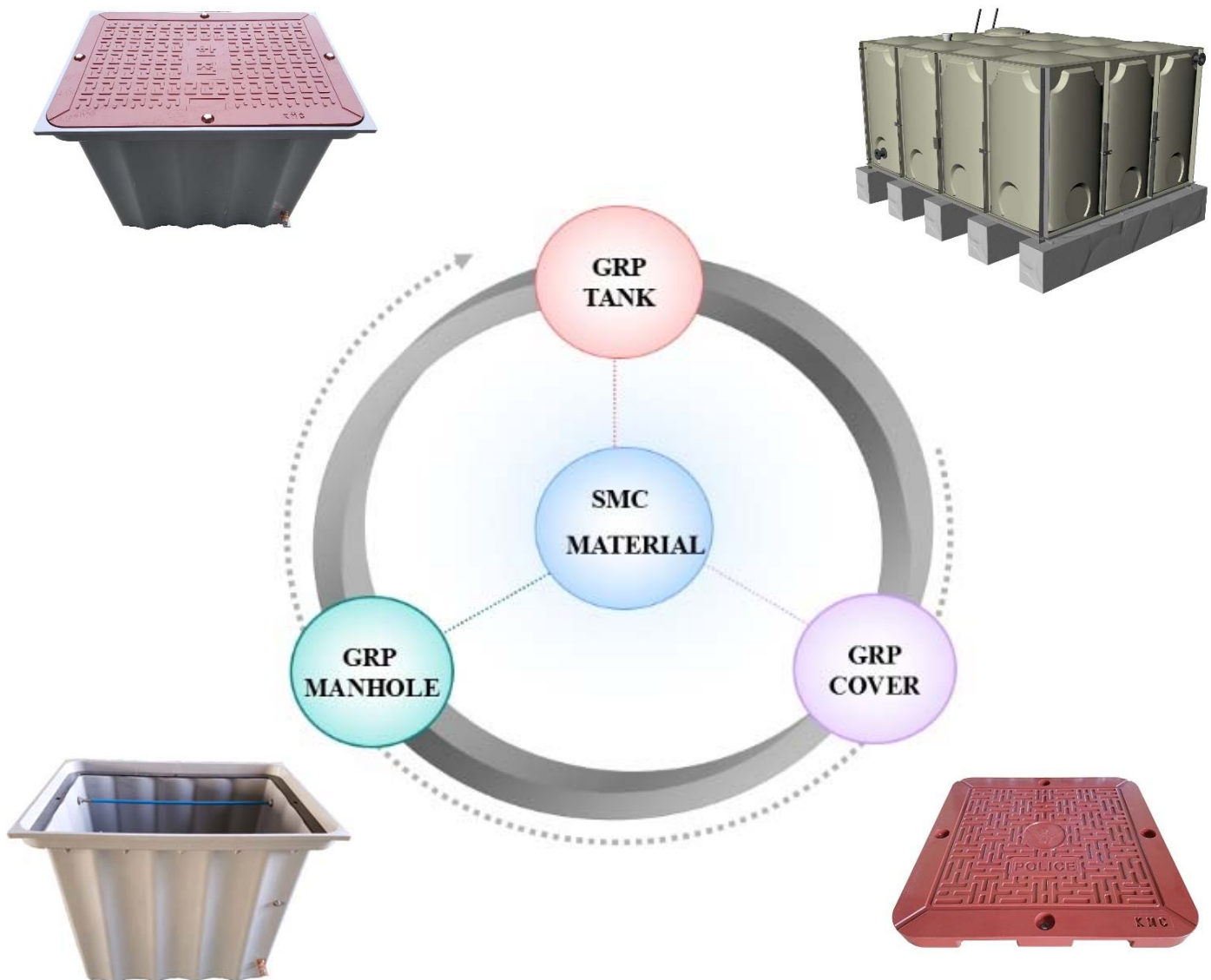

Sales Region - Exported

- ASIA : KOREA , JAPAN , CHINA , MONGOLIA , HONGKONG , SINGAPORE , VIETNAM , MIYANMA
- MIDDLE EAST : UAE, QATAR , OMAN , SAUDI ARABIA , BAHRAIN , KUWAIT
- AFRICA : SUDAN ,
- AMERICA : DOMINICA , GUYANA
- EUROPE : TURKEY , POLAND
- AUSTRALIA : NEWZEALAND ,

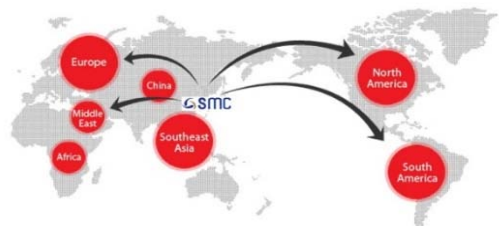

What is GRP Water Tank?

Ideal of strong for clean Drinking Water

GRP Sectional Panel Tanks are constructed of panels made from SMC (Sheet Molding Compound) by hydraulic hot press under high temperature (150 °C) and pressure conditions to maintain the best endurance.

Using stainless steel for the interior structure and plated steel for the exterior, the panel Exhibits excellent resistance to erosion.

Easy insllation with on-site bolt assembly and Tank shape and volume can be freely Designed with no restrictions based on site location, weather or climate.

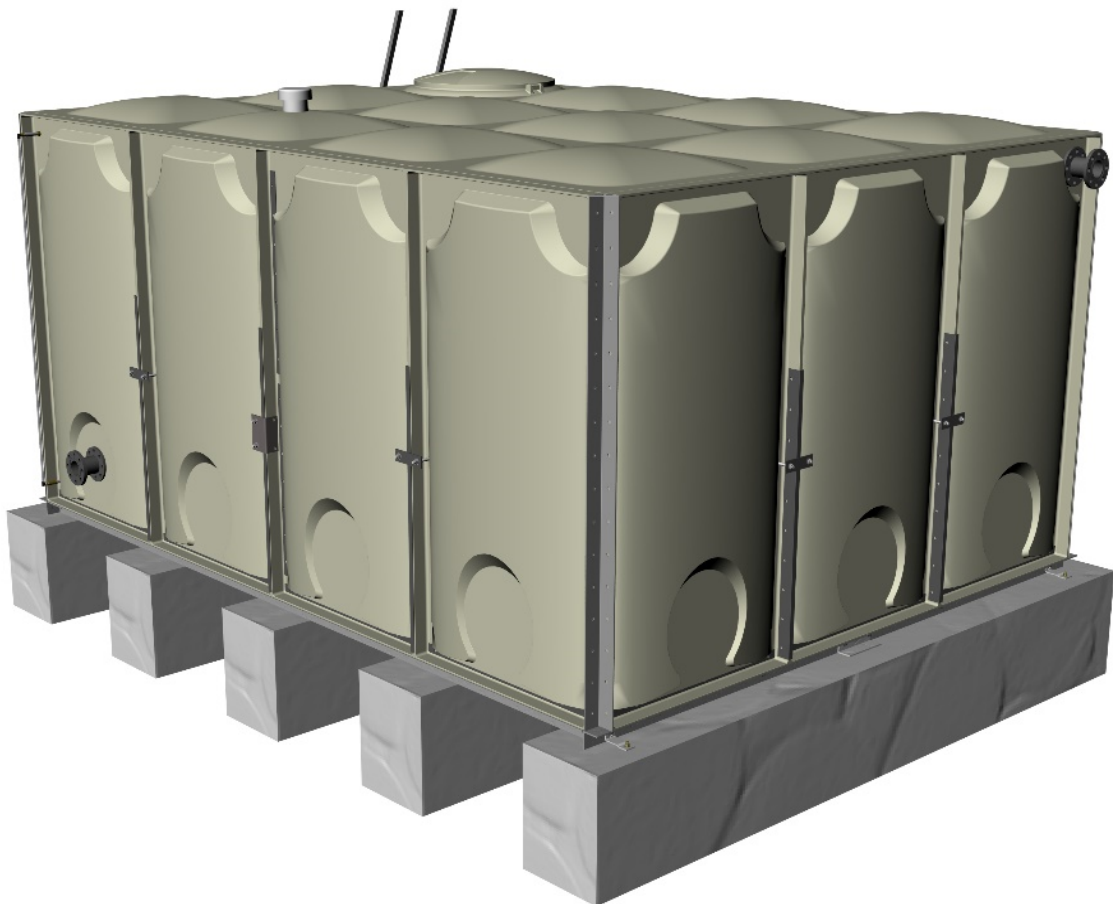

CAPACITY

Height	Width (M)	Length (M)		Height (M)	Capacity		Remark
		L - 1	L - 2		Ton	US Gallon	
1M	1	1		1	1.0	264	
	1	2		1	2.0	528	
	2	2		1	4.0	1,057	
	2	2.5		1	5.0	1,321	
	5	5		1	25.0	6,605	
	5	2	3	1	25.0	6,605	Partition
1.5M	1	1		1.5	1.5	396	
	2	2		1.5	6.0	1,585	
	2	3		1.5	9.0	2,378	
	2.5	4		1.5	15.0	3,963	
	3	5		1.5	22.5	5,945	
	5	8		1.5	60.0	15,852	
	5	4	4	1.5	60.0	15,852	Partition
2.0M	1	1		2	2.0	528	
	2	2		2	8.0	2,114	
	2	2.5		2	10.0	2,642	
	3	5		2	30.0	7,926	
	5	5		2	50.0	13,210	
	5	10		2	100.0	26,420	
	5	5	5	2	100.0	26,420	Partition
2.5M	1	2		2.5	5.0	1,321	
	2	2		2.5	10.0	2,642	
	3	4		2.5	30.0	7,926	
	4	5		2.5	50.0	13,210	
	5	8		2.5	100.0	26,420	
	5	4	4	2.5	100.0	26,420	Partition
3.0M	2	2		3	12.0	3,170	
	3	3		3	27.0	7,133	
	4	5		3	60.0	15,852	
	5	6		3	90.0	23,778	
	5	10		3	150.0	39,630	
	5	5	5	3	150.0	39,630	Partition

FEATURE

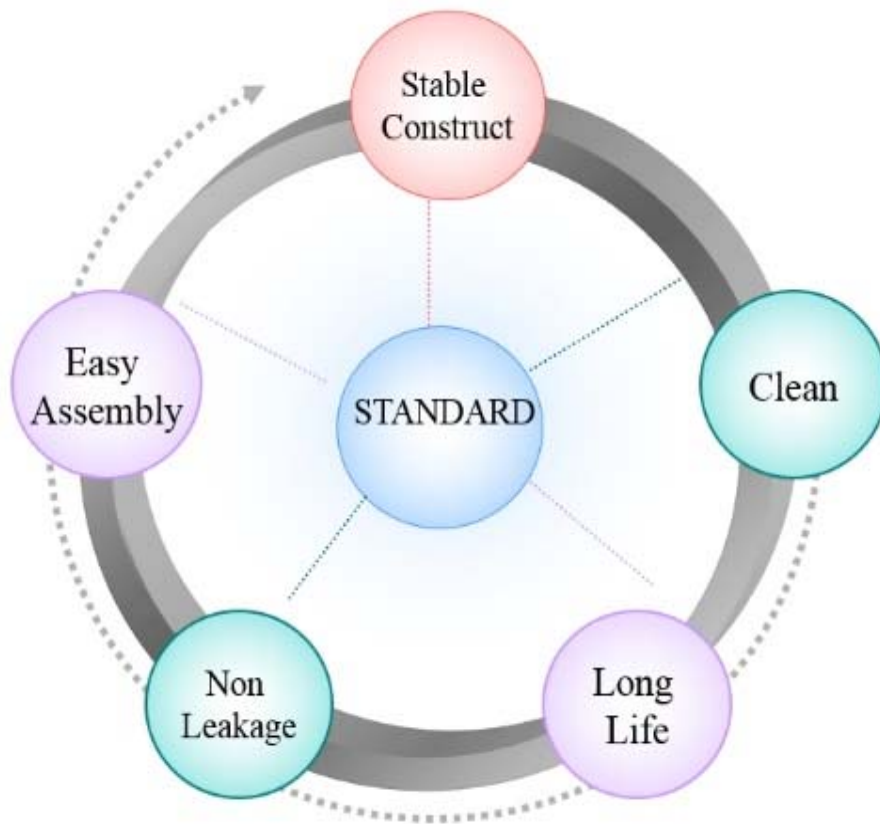

Super Hygienic

※ Hygienic SMC Panel

It is possible to make the GRP panels in a variety of colours. In most cases, however, this Type of tank is installed in the open, exposed to direct sunlight. If the GRP panels are Transparent, the growth of algae and other micro-organisms would be accelerated.

SMC has adopted panel to minimize this problem, completely opaque and does not permit the passage of any light through it.

A typical problem with steel tanks has always been the high thermal conductivity and expansion of coefficient of steel.

These characteristics can cause loosening of the panel connecting bolts in areas of wide temperature change.

Various Capacity

Sizes adaptable to any needs

From small tanks to large, SMC panel can fit virtually any order.

Tank sizes are selectable to fit each need and desire,

SMC tank can be installed to Handle from 0.25(m³) up to NO LIMIT !

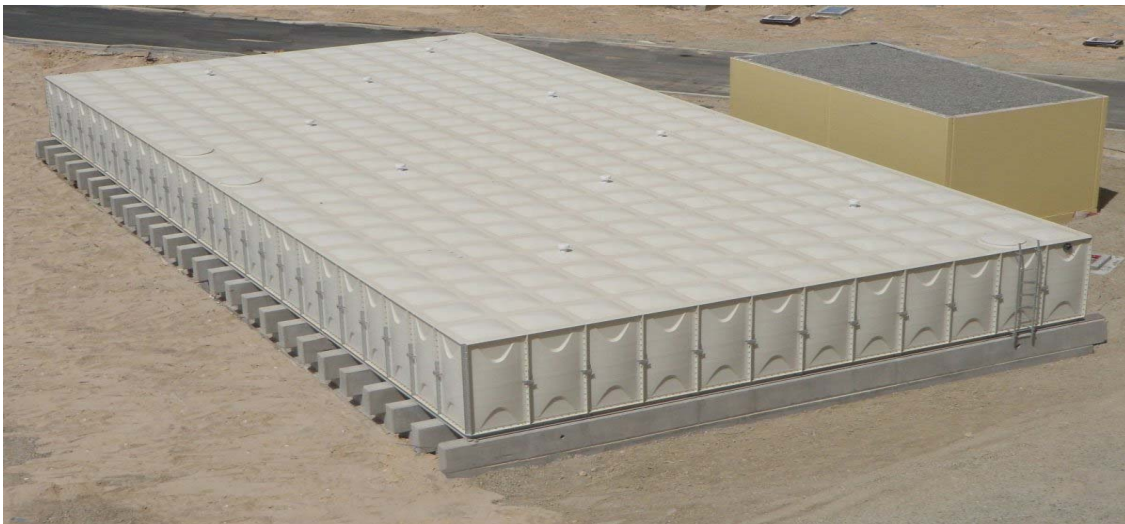

Various sized panels can make the below tanks that utilize the most horizontal & perpendicular space and also can be used as home use small tanks & Big ones.



Safety of Water Pressure

The water pressure created by filling the tank seals the joints preventing leakage
 In other type tanks, water pressure can open the joints breaking the seal,
 Water to leak out. and allowing the stored Water to leak out.

► Hydrostatic Test

In accordance with SS245:1995 Specification for
 Glass Reinforced Polyester Sectional Water Tank.

* Test Pressure : $ghp \times 6 = 2.4\text{bar}$
 $(9.81 \times 4 \times 1,000 \times) / 10.6$



► Earthquake Test

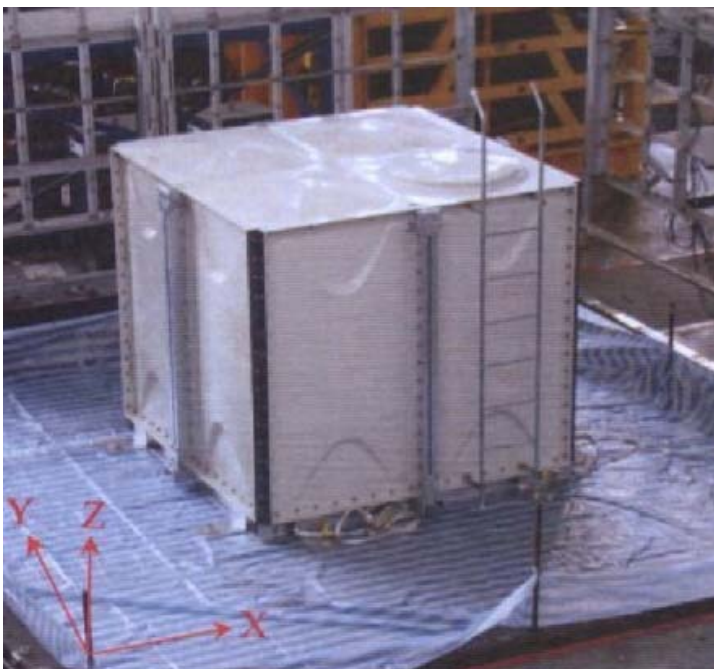

👍 Excellent Insulation

The heat insulation panel with 3 layer structure Improve heat insulation effect, protects water condensation on the outside of the tank and minimizes temperature variation of the stored water.

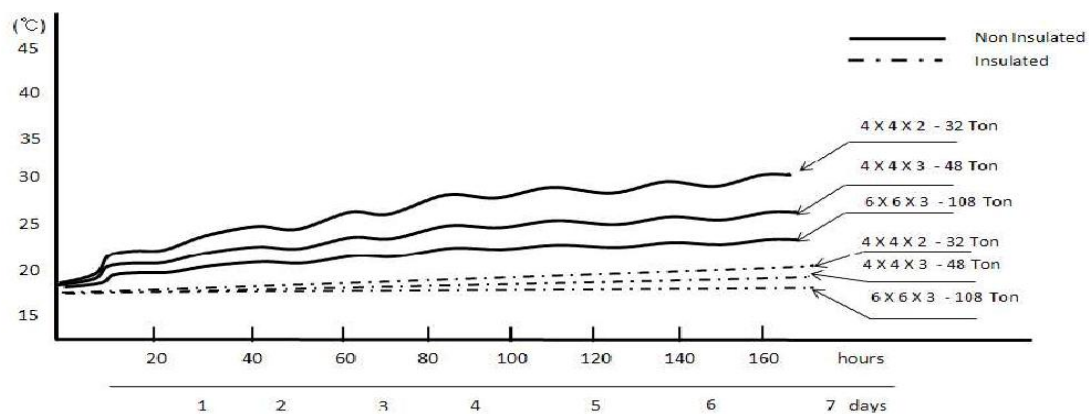
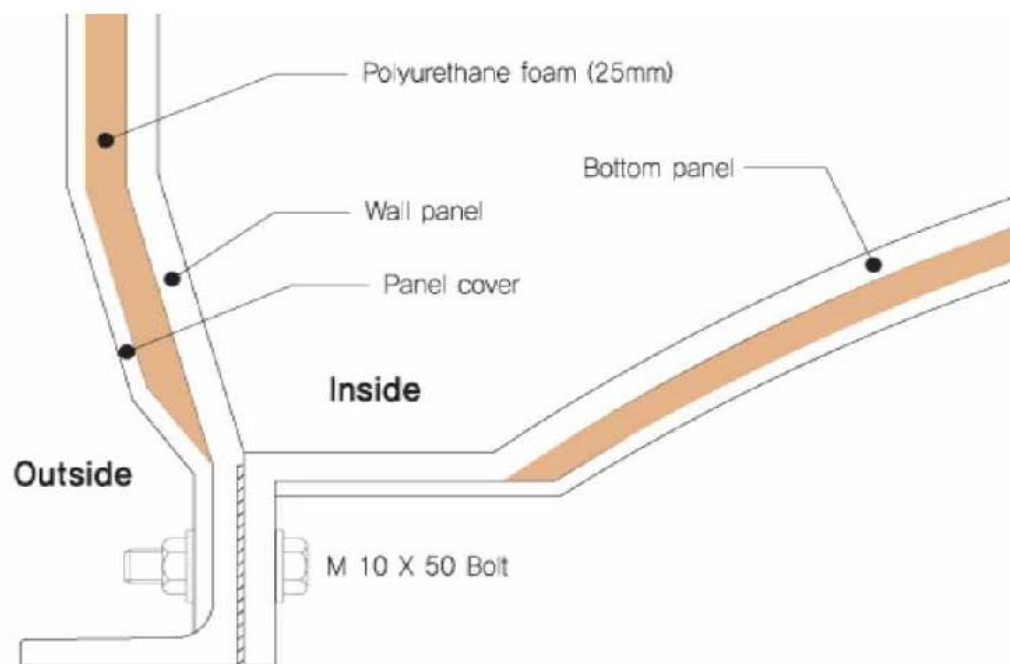
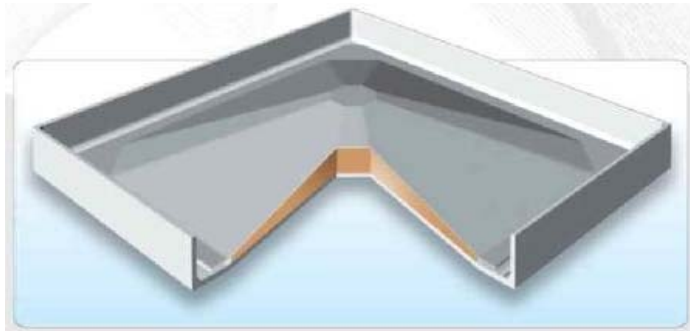

👍 Water Tightness

The joints are sealed with a special sealing tape especially developed for SMC TANK with long experience and technology on SMC products.

It maintains soft itself and adhesives even at low temperature.

The combined flange thickness at the panel joints is sufficient to meet any stress imposed.

This self sealing feature eliminates the possibility of separation and hence prevents leakage of the tank.

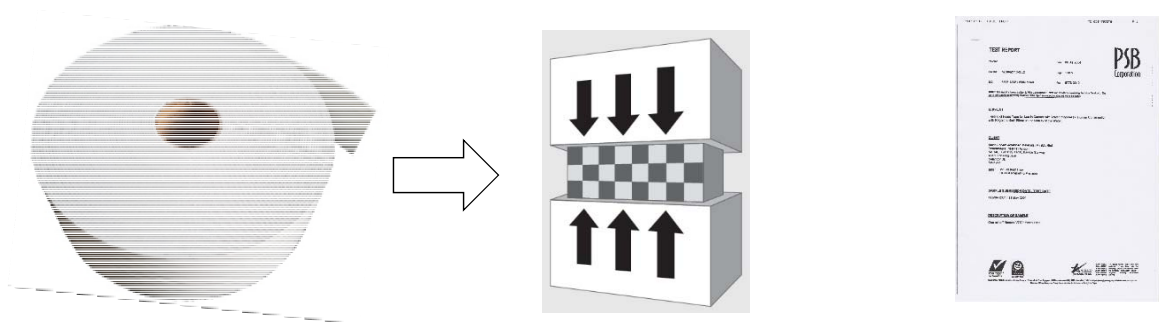

※ Material : PVC Foam
- Roof : 30mm
- Corner : 120mm
- Panel, Bracket : 50mm

※ 96% thickness restored initial
24 hours after compressing
with sealing tapes.

※ PSB Test Report
For sealing tape.

👍 Complete Drainage

The convex bottom panels with can cave drained panel system make sure complete and fast drainage.

It's very useful to take a maintenance inside of water tank.

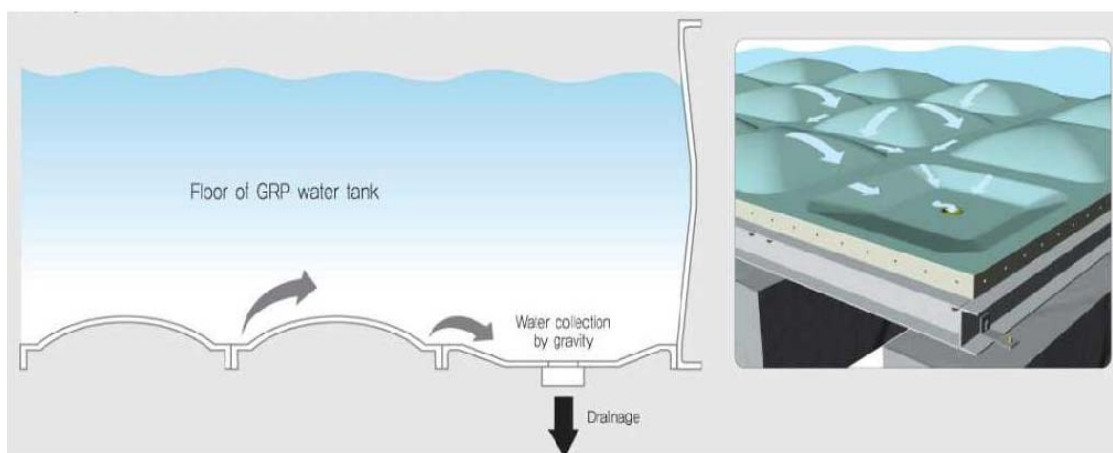

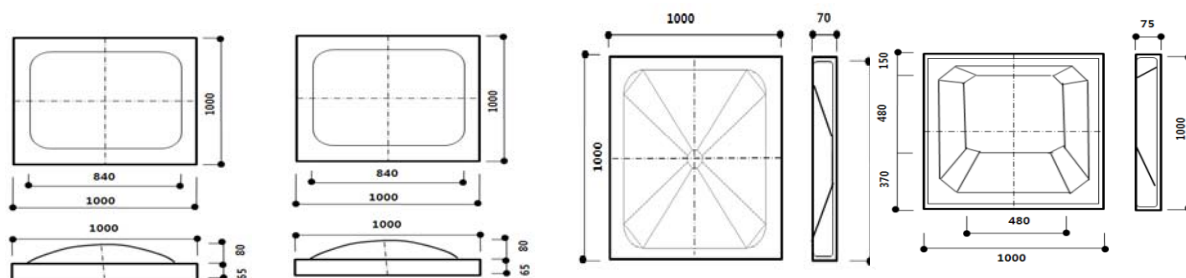
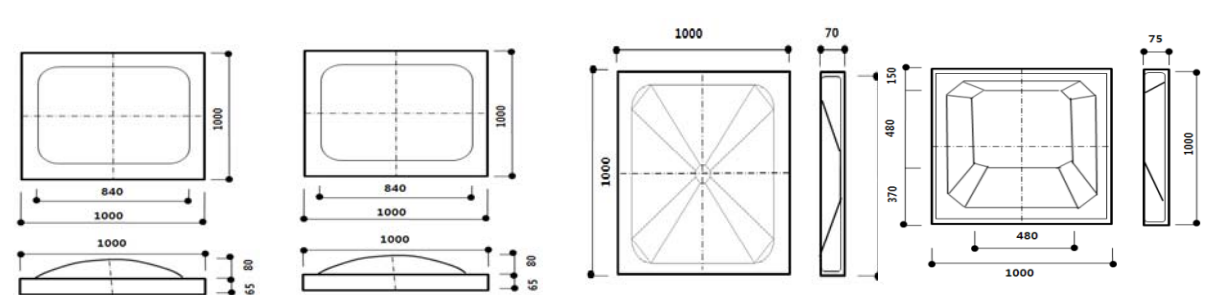

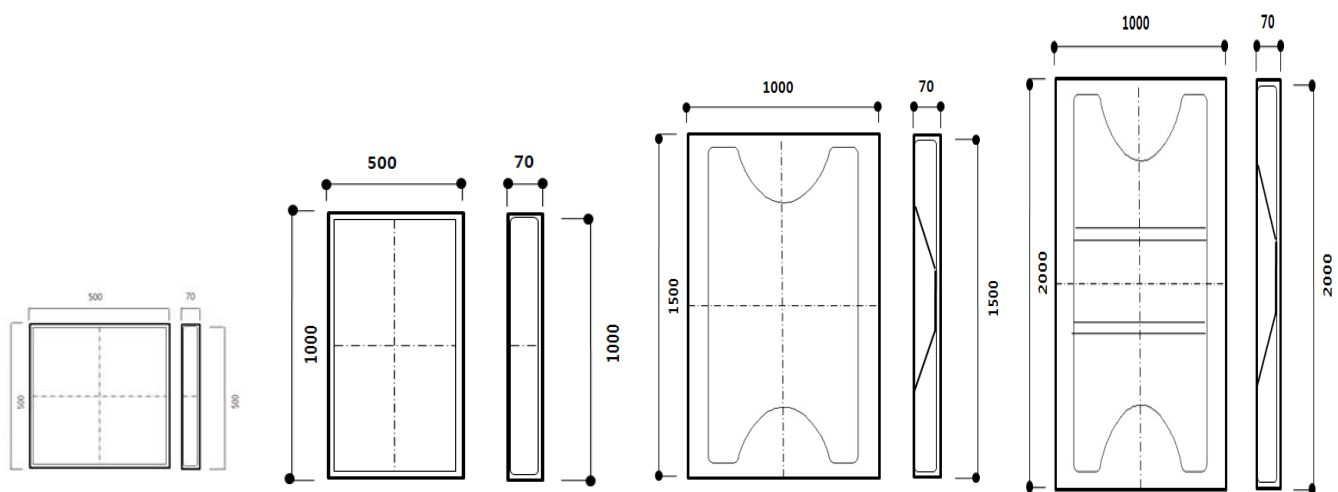
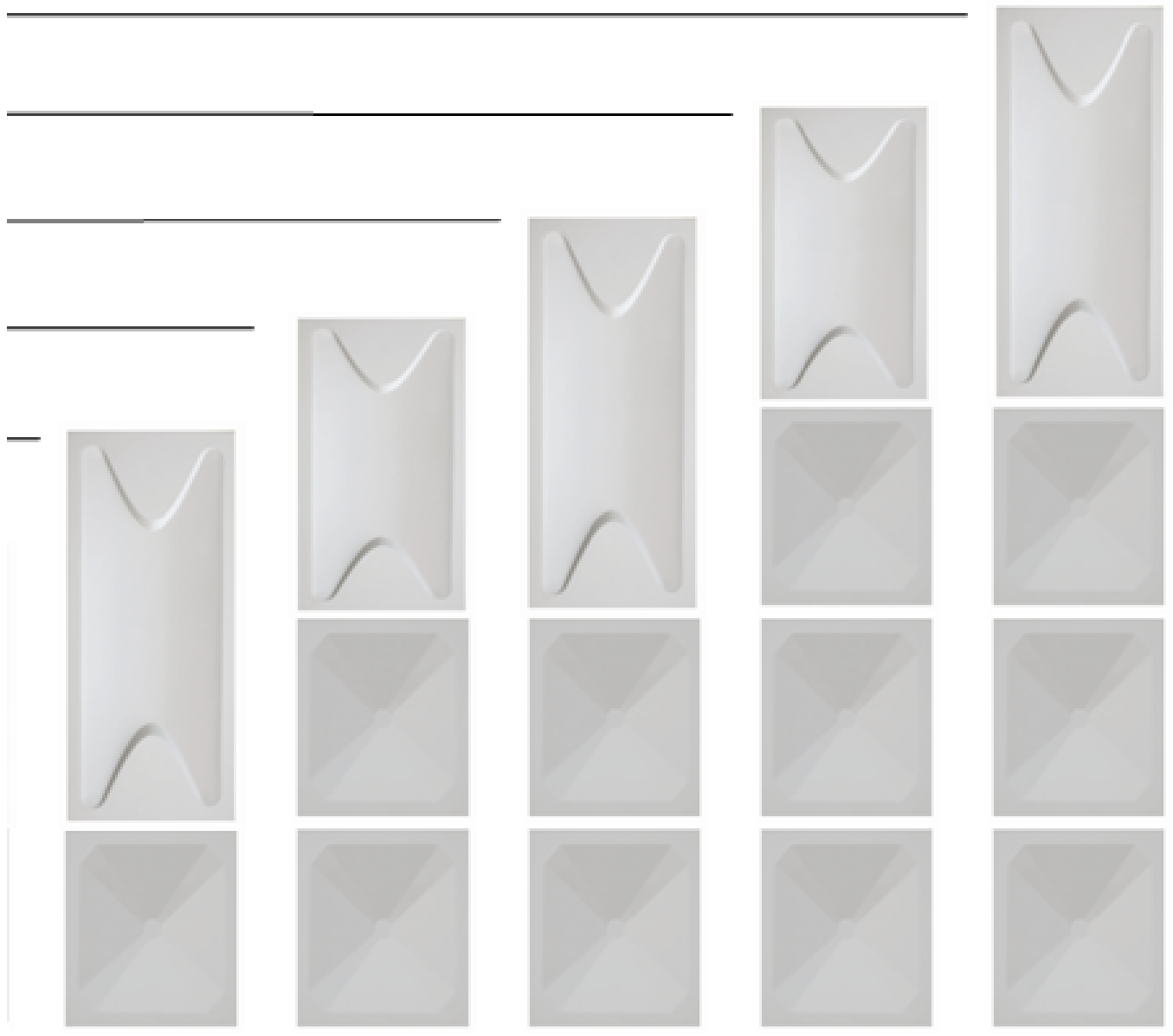

REINFORCING SYSTEM

- INTERNAL SYSTEM - 3M Height

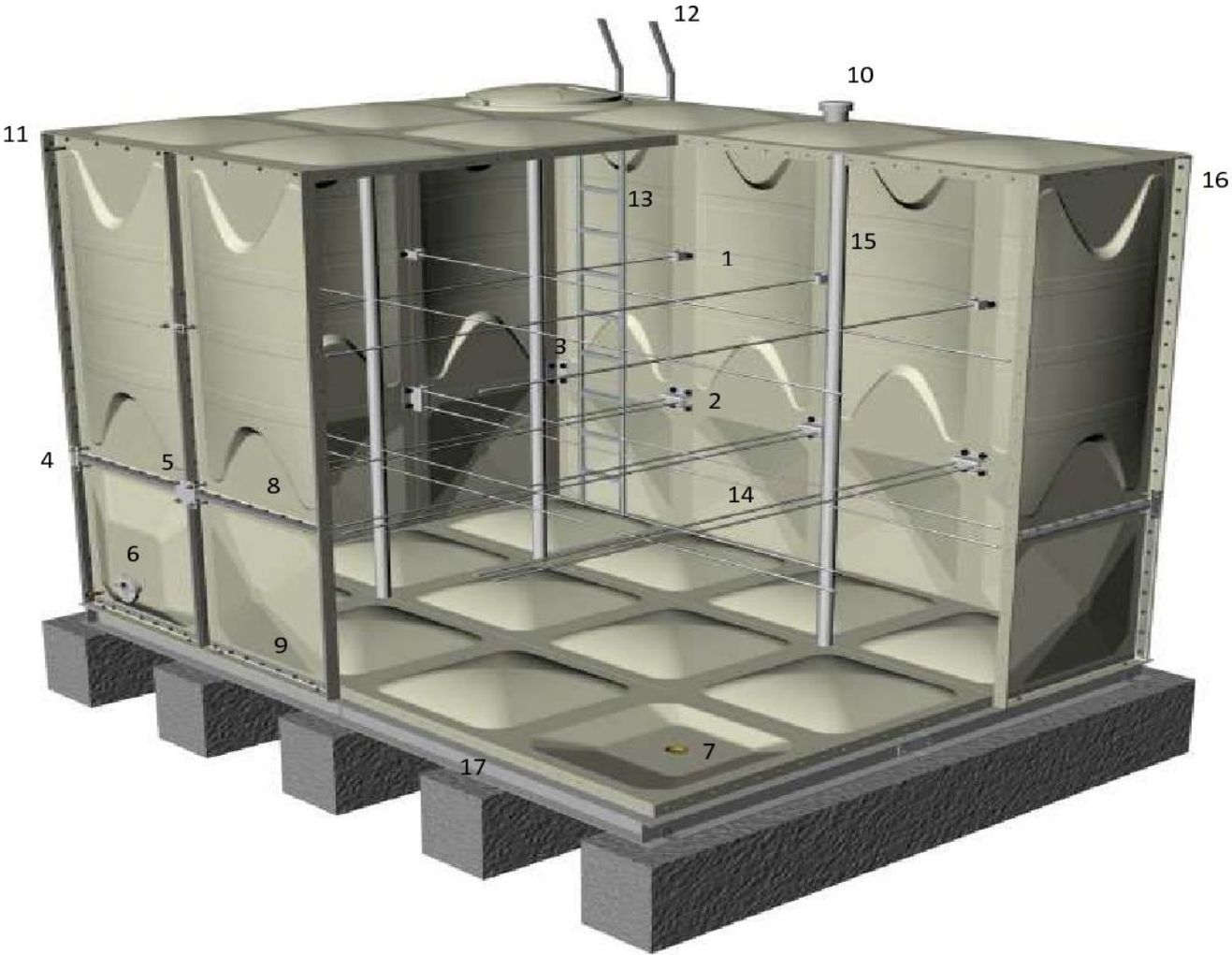

	Part's Name		Part's Name		Part's Name
1	Inside Bracket (2Holl)	7	Drain	13	Internal Ladder
2	Inside Bracket (4Holl)	8	Reinforcing Angle	14	Tie rods
3	Corne Bracket	9	Flat Bar	15	Roof Pole
4	Outer Bracket (2Holl)	10	Air Vent	16	Corner Flame
5	Outer Bracket (4Holl)	11	Water Level guage	17	Steel Skid
6	Fitting (Outlet)	12	External Ladder		

- EXTERNAL SYSTEM - 3M Height



► External Sectional Panel Water Tank in JAPAN



PARTITION

If tanks for two different uses are needed in a confined area or boiler room, a 16 ton partition type tank can be installed to use half for deinking water, and half for service water.

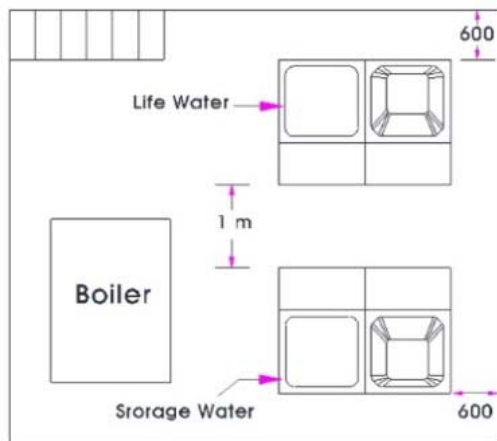

$1.5\text{M} \times 2.0\text{M} \times 2.0\text{M} = 6\text{Ton}$
 $6\text{Ton} \times 2 \text{ Nos} = 12\text{Ton}$

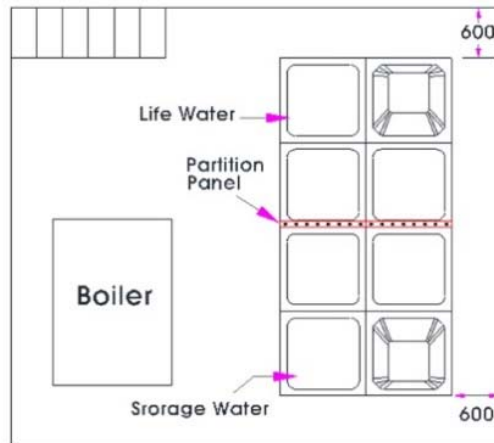

$2.0\text{M} \times (2.0\text{M} + 2.0\text{M}) \times 2.0\text{M} = 16\text{Ton}$
 $16\text{Ton} \times 1 \text{ No} = 16\text{Ton}$

- ➡ Utilizing Maximum Capacity
- ➡ Various uses
- ➡ Easy maintenance
- ➡ Cost Effectiveness



■ Partition Panel

Perfect structure with various partition panels.

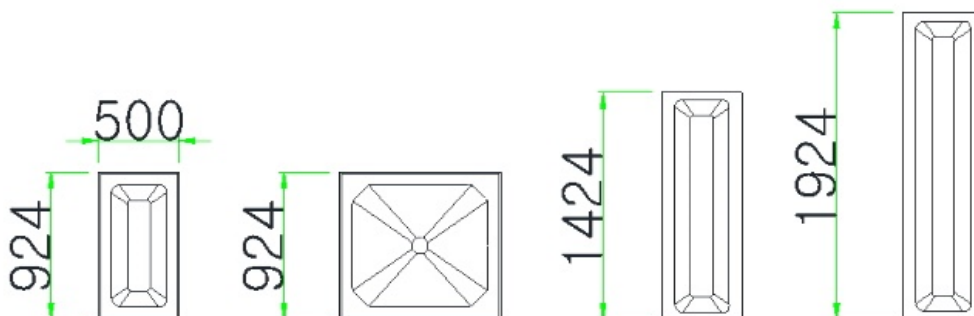

Concrete Plint & Steel Foundation

Base Concrete (Standard)

- Wide : 400mm
- Height : 500mm
- Space : Max 1m
- Outer Dimension : W+400mm

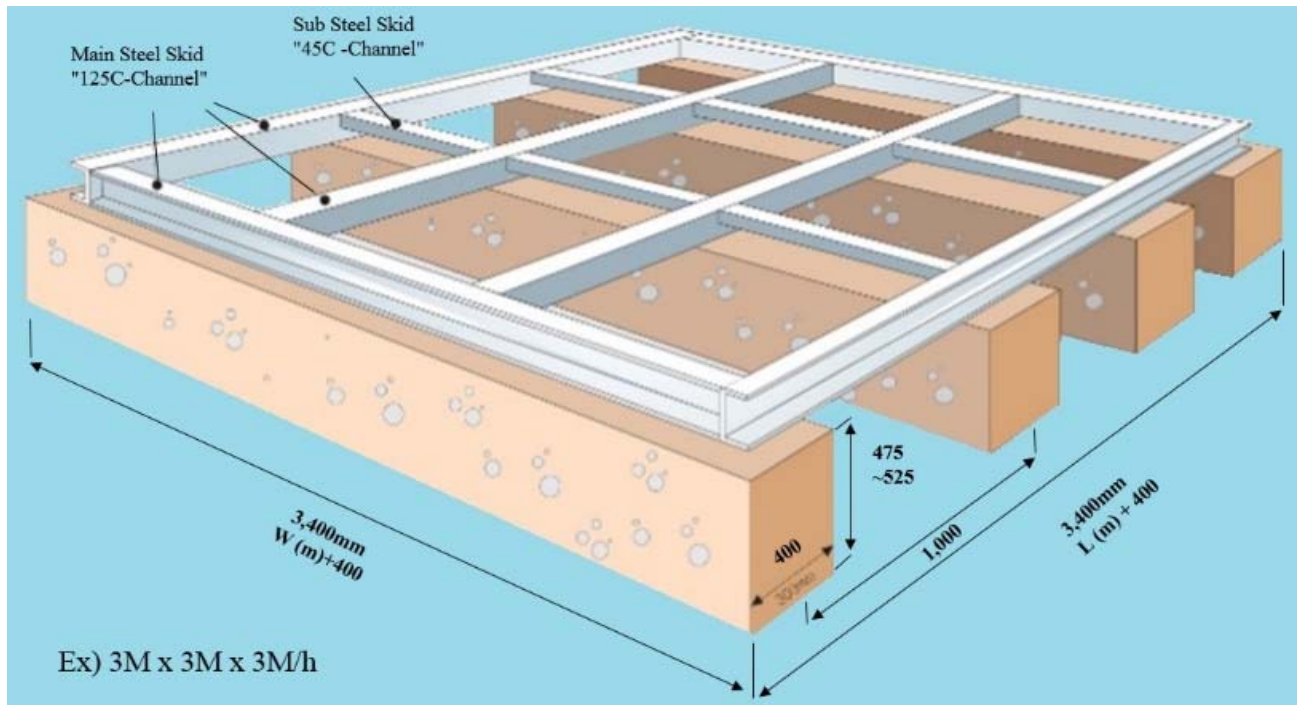

Steel Skid (Standard)

Thank Height	Main Steel Skid Shape / Dimension	Sub Steel Skid Shape / Dimension
1M ~ 2M	Angle Type 75*75*6mm(T)	D-Channel Type 75*40*3mm(T)
		
2.5M ~ 4M	C-Channel 65*125*6.5mm*8mm(T)	D-Channel Type 75*40*5mm(T)
		
4.5M ~ 5M	C-Channel 75*150*8mm*10mm(T)	D-Channel Type 100*50*6mm(T)

FITTING

The customer designates the size of socket for plumbing.

※ Standard Connection Size

Tank Capacity	Inlet	Outlet	Overflow	Drain	Airvent
1 m ³ ~ 5 m ³	25 A	50 A	65 F	40 A	50 A
6 m ³ ~ 10 m ³	40 A	65 F	65 F	40 A	50 A
11 m ³ ~ 20 m ³	40 A	65 F	65 F	40 A	50 A
21 m ³ ~ 50 m ³	50 A	80 F	80 F	40 A	50 A
51 m ³ ~ 100 m ³	80 F	100 F	125 F	50 A	100 A
101 m ³ ~ 200 m ³	80 F	150 F	125 F	50 A	100 A
201 m ³ ~ 500 m ³	100 F	200 F	150 F	80 F	100 A
501 m ³ ~	100 F	200 F	150 F	80 F	100 A

※ Size of Flange (JIS 10K)

mm / inch	D	T1	T2	G	L	C	Hole
65A (2½)	175	20	25	77	140	140	4
80A (3)	185	20	25	90	140	150	8
100A (4)	210	20	25	115	140	175	8
125A (5)	250	20	25	140	140	210	8
150A (6)	280	20	25	170	140	240	8
200A (8)	330	22	25	220	150	290	12
250A (10)	400	24	25	270	170	355	12
300A (12)	445	24	25	320	170	400	16

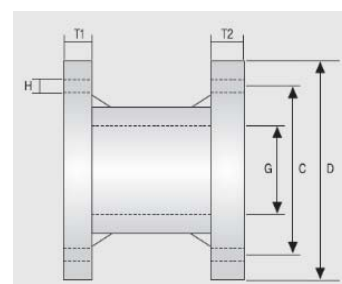

※ Size of Socket (CAC)

mm / inch	D	D1	L	T
15A	43	19	26	1.5
20A	46	25	30	1.5
25A (1)	53	31	32	1.5
32A (1½)	66	39	35	1.5
40A (1½)	73	45	36	1.5
50A (2)	85	57	40	1.5
65A (2½)	111	72	46	2

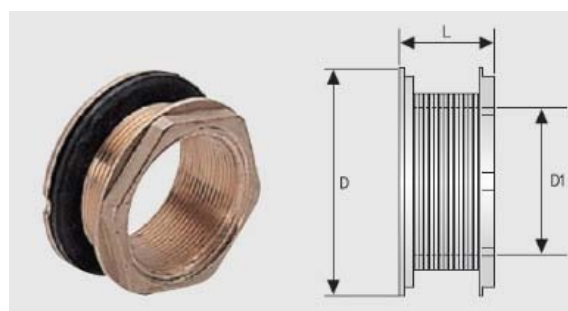



CAUTION

DELIVERY

- Do not put an intensive load or impact while moving the tank.



PIPING

- Install a prop while installing piping and take care not to put an excessive load.
- Install pipes on the site where the tank is located and take care not to put on a biased load.
- Take precautions to avoid fire or other occurrences accidents while welding



MAINTENANCE

- Do not place fire near the water tank.
- Do not put excessive weight on the Roof.
- Do not work on the stiffener (Bracket) because it will cause leakage.
- If is not used for a long time, be sure to drain the water from the tank.
- As the tank is a reservoir of water for consumption by people, inspection should be done for safety. (more than twice a year)

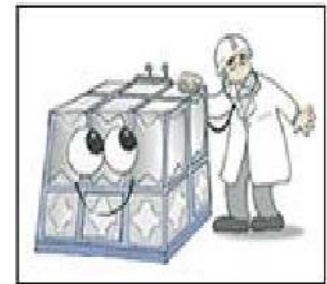

Exclusive Agent

We do best for your business

SMC CO.,LTD

Contact

Head Quarter

#194-6, Yulma-Ro, Daegot-Myun, Gimpo-City, Gyeonggi-Do, Korea

GRP TANK Dep't : Tel. +82(31) 997 8704 Fax. +82(31) 997 8705

GRP TANK Dep't : Tel. +82(31) 989 8710 Fax. +82(31) 989 8705

Factory

#592-20, Asanman-Ro, Seonjang-Myun, Asan-City, Chungnam-Do, Korea

● Website -Korean : www.smctank.co.kr E-Mail : info@smctank.co.kr

Website-English : www.grptank.com E-Mail : info@grpctank.com